

SCREW IN TOOL

1. How to set the Screw-in head

1. Prior to setting the head, please air-blow the connecting part of the head and the arbor.
2. Please tighten the head at the recommended torque for a complete contact of the head and the arbor.

Screw size	Recommended torque (Nm)	Wrench size (mm)
M8	23	10
M10	46	14
M12	80	19
M16	90	24

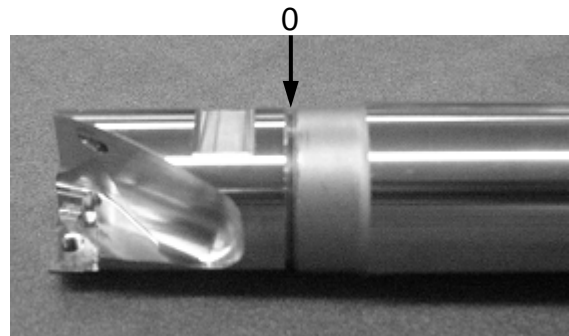
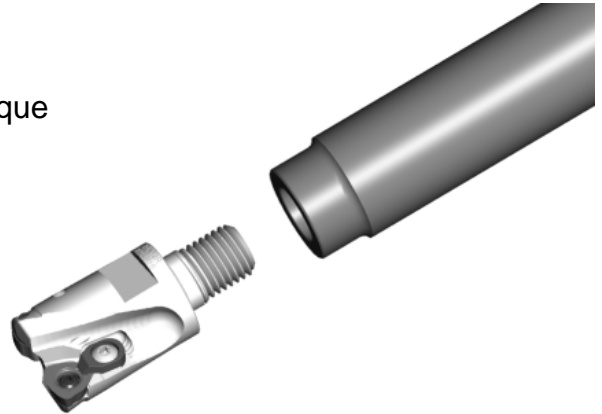

2. Attention

Please use our original products when you use "Screw-in tool".

3. Other instructions

1. Please refer to tools-news about cutting conditions.
2. There is a danger of burn, if you touch the tool soon after cutting.
3. Don't touch the cutting edge of the insert with bare hand to prevent injury.